



THE SIEMENS ADVANTAGE

# Revised P1 Panels

## Ready to Assemble Panelboards

[siemens.ca/powerdistribution](https://www.siemens.ca/powerdistribution)

**SIEMENS**



# Revised P1 Panels – Ready to Assemble Panelboards (RTAP)

To better serve the needs of our customers, we are proud to announce that we are an Authorized Siemens RTAP Distributor. What this means to you is product flexibility, quicker job turn-around, and affordable pricing. All Siemens ready to assemble panelboards are fully backed for high-quality and trouble-free operation.

## Same day availability

Over the counter availability means you're on and off the job without the delays that come with waiting for factory assembled panelboards.

## Product consistency

Whether you are starting a new project, replacing parts, or adding on to an existing project, the RTAP offering is an exact match to the Siemens factory built panelboards (feed-thru versions only). While this ensures that you enjoy the same great features of the P1 panelboard, it also guarantees your job sites will have the same look, quality, and parts whether you ordered them factory-built, utilized our RTAP inventory, or used a combination of the two. (Note: Non-feed-thru variations are available as factory assembled without subfeed space in a 6" (152 mm) shorter enclosure.)

## Flexibility and ease of assembly

Customer oriented design creates installation convenience. For all of its one-of-a-kind features,

the P1 panelboard is also designed to be extremely user-friendly. For instance, field convertible main breaker and main lug kits, (through 400 amps), will allow you to switch from main lug to main breaker, and vice versa with no change in box size or additional cabling. Plus, lay-in construction and/or removable lugs make wiring the main and neutral lugs easier and faster. To further speed wiring, as well as reduce clutter, the P1 panel also features a split neutral design and branch neutral connections are near the breaker connections. Additionally, field addable sub-fed breakers (up to 250 amps) or feed through lug kits can be field installed without utilizing any of your feeder breaker positions or increasing your box height. Furthermore, the unique design allows the panel to be inverted in the field and keep its labeling legible.

## New for Revised P1 Panels

- 1) BL/BQD and NGB type Mains are only allowed as Back-Fed Mains in unit space. This uses 2 or 3 positions of unit space, but saves the cost of a strap kit.
- 2) 54 circuit 250A and 400A panels are now available.
- 3) 2/0 neutral kits are now available as field installable accessories.
- 4) 750 kcmil Main Lug kits are now available for 400A Panels.

# Revised P1 Panels – Ready to Assemble Panelboards offer a wealth of features and benefits!

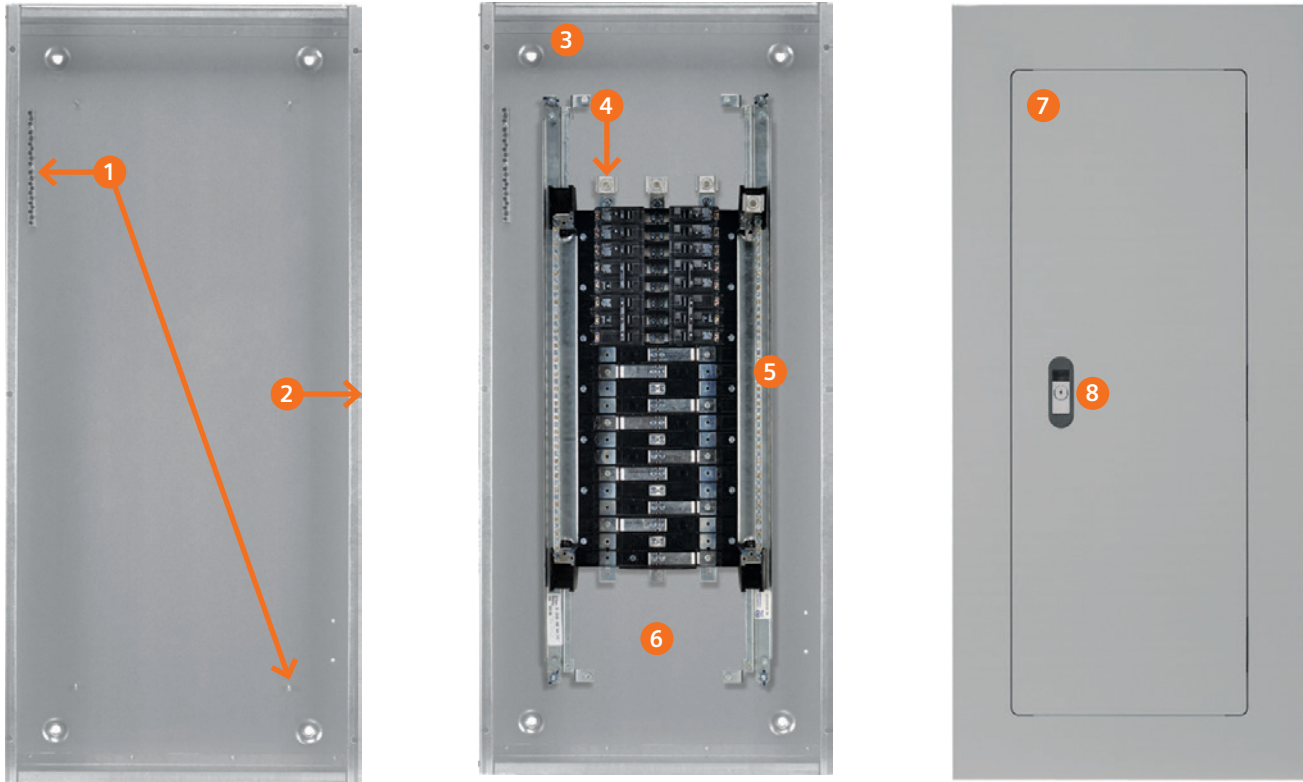

- 1 Completely symmetrical boxes may be mounted with either end up. There are four pre-punched equipment ground connector locations for contractor-friendly installation.
- 2 Box comes pre-punched for optional, field-installable door-in-door or hinged style trims. There are also four pre-punched ground connector locations. The panel box will accept both standard ground connector (EGK and ECGK) assemblies and insulated ground connector kits (IGK and ICGK).
- 3 Interior is completely symmetrical allowing it to be changed from top to bottom feed by simply rotating the interior.
- 4 Choose either a Main Breaker kit or Main Lug kit with which to terminate your incoming cables. Main lug kits are contractor-friendly with lay in lugs (or removable lugs) through 350 Kcmil (250 amp panel) or (1) 600 Kcmil or (2) 250 Kcmil connectors for 400 amp panels. Main Breaker kits (250 amps and below) are horizontally mounted allowing field convertible top or bottom feeds to be performed easily. Main Lug kits and Main Breaker Kits are interchangeable and can be changed/ added in the field without making changes to the enclosure or interior.
- 5 Branch neutral connections are near the breaker connections to speed wiring and reduce clutter. The standard P1 neutral is rated for 100% of the panel's ampacity and will accept copper or aluminum wire. Optional 200% neutral kits and 2/0 neutral kits are also available.
- 6 The panel includes space to add (1) sub-feed breaker (max 250 amps), feed-thru lugs or TPS3 (SPD) kit.
- 7 Siemens standard trim has hidden hinges and mounting hardware for added safety. The rounded door corners not only enhance the panel's appearance but also help to eliminate injuries caused from sharp corners.
- 8 Semi-flush lock comes standard. Easily identified locked position denoted by keyway being horizontal when door has been locked.

# Ordering is as easy as 1, 2, 3, 4

## 1 Select the three main components for Revised P1 Panels: Interior, Box & Trim

1 Phase, 3 Wire uses BL, BLH, or HBL style breakers					120/240V
Bus ampere rating	Max. no. of circuits	Revised P1 Catalogue no.	Box Catalogue no. <sup>1</sup>	Trim Catalogue no. <sup>2</sup>	Bus Material
250	18	P1A18ML250AT	B32	S/F32B	Aluminum
	30	P1A30ML250AT	B38	S/F38B	
	42	P1A42ML250AT	B44	S/F44B	
	54	P1A54ML250AT	B50	S/F50B	
400	30	P1A30ML400AT	B62	S/F62B	Aluminum
	42	P1A42ML400AT	B68	S/F68B	
	54	P1A54ML400AT	B74	S/F74B	
250	18	P1A18ML250CT	B32	S/F32B	Copper
	30	P1A30ML250CT	B38	S/F38B	
	42	P1A42ML250CT	B44	S/F44B	
	54	P1A54ML250CT	B50	S/F50B	
400	30	P1A30ML400CT	B62	S/F62B	Copper
	42	P1A42ML400CT	B68	S/F68B	
	54	P1A54ML400CT	B74	S/F74B	

3 Phase, 4 Wire uses BL, BLH or HBL style breakers					120/208V
250	18	P1C18ML250AT	B32	S/F32B	Aluminum
	30	P1C30ML250AT	B38	S/F38B	
	42	P1C42ML250AT	B44	S/F44B	
	54	P1C54ML250AT	B50	S/F50B	
400	30	P1C30ML400AT	B62	S/F62B	Aluminum
	42	P1C42ML400AT	B68	S/F68B	
	54	P1C54ML400AT	B74	S/F74B	
250	18	P1C18ML250CT	B32	S/F32B	Copper
	30	P1C30ML250CT	B38	S/F38B	
	42	P1C42ML250CT	B44	S/F44B	
	54	P1C54ML250CT	B50	S/F50B	
400	30	P1C30ML400CT	B62	S/F62B	Copper
	42	P1C42ML400CT	B68	S/F68B	
	54	P1C54ML400CT	B74	S/F74B	

<sup>1</sup> All box dimensions are 20"w x 5.75"d. Height dimensions are equal to the last two digits of the box's catalogue number.

<sup>2</sup> Catalogue number begins with either S for surface or F for flush front (i.e. S32B or F32B).

**1** Select the three main components for Revised P1 Panels:  
Interior, Box & Trim

<b>3 Phase, 4 Wire uses BQD6 style breakers</b>					<b>600Y/347V</b>
Bus ampere rating	Max. no. of circuits	Revised P1 Catalogue no.	Box Catalogue no. <sup>1</sup>	Trim Catalogue no. <sup>2</sup>	Bus Material
250	18	P1L18ML250AT	B32	S/F32B	Aluminum
	30	P1L30ML250AT	B38	S/F38B	
	42	P1L42ML250AT	B44	S/F44B	
	54	P1L54ML250AT	B50	S/F50B	
400	30	P1L30ML400AT	B62	S/F62B	Aluminum
	42	P1L42ML400AT	B68	S/F68B	
	54	P1L54ML400AT	B74	S/F74B	
250	18	P1L18ML250CT	B32	S/F32B	Copper
	30	P1L30ML250CT	B38	S/F38B	
	42	P1L42ML250CT	B44	S/F44B	
	54	P1L54ML250CT	B50	S/F50B	
400	30	P1L30ML400CT	B62	S/F62B	Copper
	42	P1L42ML400CT	B68	S/F68B	
	54	P1L54ML400CT	B74	S/F74B	

<b>3 Phase, 4 Wire uses NGB/3VA41 style breakers</b>					<b>600Y/347V</b>
250	18	P1L18ML250AT-NGB	B32	S/F32H	Aluminum
	32	P1L30ML250AT-NGB	B38	S/F38H	
	42	P1L42ML250AT-NGB	B44	S/F44H	
400	30	P1L30ML400AT-NGB	B62	S/F62H	Aluminum
	42	P1L42ML400AT-NGB	B68	S/F68H	
250	18	P1L18ML250CT-NGB	B32	S/F32H	Copper
	30	P1L30ML250CT-NGB	B38	S/F38H	
400	42	P1L42ML250CT-NGB	B44	S/F44H	Copper
	30	P1L30ML400CT-NGB	B62	S/F62H	
	42	P1L42ML400CT-NGB	B68	S/F68H	

<sup>1</sup> All box dimensions are 20" w × 5.75" d. Height dimensions are equal to the last two digits of the box's catalogue number.

<sup>2</sup> Catalogue number begins with either S for surface or F for flush front (i.e. S32B or F32B).

<sup>3</sup> This panel only accepts NGB/3VA41 breakers in the branch-feeder positions.



# Ordering is as easy as 1, 2, 3, 4

- 2** Select main breaker kit or feed-thru lug kit (if required).  
Main/subfeed breaker mounting kits may be ordered with or without breaker.

## Main and Subfeed Breaker Mounting Kits without Breakers<sup>1</sup>

Ampere rating	Breaker Types	Service	Revised P1 Catalogue no.
100A	BQD	3 Phase	<b>Use Back-fed Main Label Kit # MBKBFA<sup>2</sup></b> (includes Neutral Lug, "MAIN" label and instructions)
100A	BL, BLH, HBL	1 Phase 3 Phase	
125A	NGB	1 Phase 3 Phase	
125A	ED4, ED6, HED4	1 Phase 3 Phase	<b>MBKED1A</b> <b>MBKED3A</b>
225A <sup>3</sup>	QR2, QRH2, HQR2, HQR2H	1 Phase 3 Phase	<b>MBKQR1A</b> <b>MBKQR3A</b>
250A	FXD6, FD6, HFD6, HFXD6	1 Phase 3 Phase	<b>MBKFD1A</b> <b>MBKFD3A</b>
400A	JXD2, JD6, JXD6, HJD6, HJXD6	1 Phase 3 Phase	<b>MBKJD3B</b>

<sup>1</sup> 400 amp kit is for main only – not allowed for subfeed breaker.

<sup>2</sup> Back-fed main breaker occupies branch space.

<sup>3</sup> Although QR is rated 250A, it is limited to 225A in panelboard.

## Lug Kits – Main or Feed Thru (for Revised P1 only)

Ampere rating	Material	Wire range	Service	Revised P1 Catalogue no.
250	Aluminum	(1) #6 AWG-350 kcmil Cu or Al	1 Phase 3 Phase	<b>MLKA1A</b> <b>MLKA3A</b>
	Copper	(1) #6 AWG-350 kcmil Cu or Al	1 Phase 3 Phase	<b>MLKC1A</b> <b>MLKC3A</b>
400	Aluminum	(2) 3/0 250 or (1) #2 AWG-600kcmil	1 Phase 3 Phase	<b>4MLKA1A</b> <b>4MLKA3A</b>
	Copper	(2) 1/0-4/0 or (1) 1/0-600 kcmil	1 Phase 3 Phase	<b>4MLKC1A</b> <b>4MLKC3A</b>
	Aluminum	(1) 1/0-750 kcmil Al or (1) 1/0-600 kcmil Cu	1 Phase 3 Phase	<b>4MKLA1B</b> <b>4MLKA3B</b>

## Main and Subfeed Breaker Mounting Kits with Breakers<sup>1</sup>

Catalogue no. <sup>3</sup>	Description	Rating	
		240V	600V
<b>MBKQR12225A</b>	Kit with 2 pole QR2 225 Amp breaker	10kA	–
<b>MBKQR33150A</b>	Kit with 3 pole QR2 150 Amp breaker	10kA	–
<b>MBKQR33200A</b>	Kit with 3 pole QR2 200 Amp breaker	10kA	–
<b>MBKQR33225A</b>	Kit with 3 pole QR2 225 Amp breaker	10kA	–
<b>MBKED33100A</b>	Kit with 3 pole ED6 100 Amp breaker	65kA	18kA
<b>MBKED33125A</b>	Kit with 3 pole ED6 125 Amp breaker	65kA	18kA
<b>MBKFD33200A</b>	Kit with 3 pole FXD6 200 Amp breaker	65kA	22kA
<b>MBKFD33225A</b>	Kit with 3 pole FXD6 225 Amp breaker	65kA	22kA
<b>MBKFD33250A</b>	Kit with 3 pole FXD6 250 Amp breaker	65kA	22kA
<b>MBKHF33250A</b>	Kit with 3 pole HFD6 250 Amp breaker	100kA	25kA
<b>MBKJD33400A<sup>2</sup></b>	Kit with 3 pole JXD6 400 Amp breaker	65kA	25kA

<sup>1</sup> If used as a Subfeed breaker, max is 250A.

<sup>2</sup> 400 amp kits usable as Top (or) Bottom feed. These kits cannot be used as a subfeed breaker since panel's subfeed space allowance is for a maximum 250 amp breaker.

<sup>3</sup> All kits listed ending in "A" will not fit Original P1 Panels.

**Note: Original P1 kits will not fit Revised P1 Panels, and Revised P1 kits will not fit original P1 Panels.**

### 3 Select P1 Panelboards ground bars and accessories

Catalogue no.	Description
BK1A <sup>2</sup>	Bonding kit for 250A max.
EGK	Al Ground Bus 44 Connections
ECGK	Cu Ground Bus 44 Connections
IGK	Insulated Al Ground Bus
ICGK	Insulated Cu Ground Bus
DFFP1A	Filler Plate can be used in place of QF3-UL (Qty=100/box)
2NLK30A <sup>2</sup>	200% Neutral Kit, 18 and 30 Circuit, 250 Amp
2NLK42A <sup>2</sup>	200% Neutral Kit, 42 Circuit, 250 Amp
2NLK54A <sup>2</sup>	200% Neutral Kit, 54 Circuit, 250 Amp
42NLK30A <sup>2</sup>	200% Neutral Kit, 30 Circuit, 400 Amp
42NLK42A <sup>2</sup>	200% Neutral Kit, 42 Circuit, 400 Amp
42NLK54A <sup>2</sup>	200% Neutral Kit, 54 circuit, 400 Amp
P1SCRWS <sup>1</sup>	Branch Breaker Mounting Screws for P1
SDKN	Dripshield kit (20" w × 5.75" d)
MBKBFA <sup>2</sup>	Back-Fed Main Breaker Label and Instructions for BL/ BQD or NGB breaker
CNLK42B <sup>2</sup>	RP1 CU Neutral Lug Kit, 42B - 2 short & 2 long strips (17 & 25 pos) contains: CU neutral strips and CU riser extension, plus all hardware to replace standard neutrals. CU strips are 1/0 max. and require CU cable
CNLK54B <sup>2</sup>	RP1 CU Neutral Lug Kit, 54B - 4 long strips (25 pos) contains: CU neutral strips and CU riser extension, plus all hardware to replace standard neutrals. CU strips are 1/0 max. and require CU cable
LNLK4X11B <sup>2</sup>	RP1 & P3 2/0 Neutral Lug Kit (15pos) [(4×)2/0 + (11×) #6] - 2/0 max neutral strips (6.17 Long)
LNLK6X17B <sup>2</sup>	RP1 & P3 2/0 Neutral Lug Kit (23pos) [(5×)2/0 + (17×) #6] - 2/0 max neutral strips (8.67 Long)
LNLK7X20B <sup>2</sup>	RP1 & P3 2/0 Neutral Lug Kit (27pos) [(7×)2/0 + (20×) #6] - 2/0 max neutral strips (9.92 Long)
NBK01A	Stick-on numbers 1–60 (includes BT - 1/2" size)
NBK02A	Stick-on numbers 61–120 (includes BT - 1/2" size)
NBK03A	Stick-on numbers 121–240 (includes BT - 1/2" size)
P1CONBPHCU <sup>2</sup>	Replacement Connector kit – 6 pcs. B phase Copper
P1CONBPHAL <sup>2</sup>	Replacement Connector kit – 6 pcs. B phase Aluminum
P1CONACPHCU <sup>2</sup>	Replacement Connector kit – 6 pcs. A or C phase Copper
P1CONACPHAL <sup>2</sup>	Replacement Connector kit – 6 pcs. A or C phase Aluminum
TPS9IKITP1A <sup>2</sup>	Mounting bracket for SPD TPS3 09

### 4 List required branch circuit breakers for P1 panelboards

Voltage	Branch Breaker Ampere rating	AIC rating	Breaker style
120/208V 120/240V	Up to 100 Amps	10k	BL
		22k	BLH
		65k	HBL
600/347V	Up to 70 Amps Up to 125 Amps	10k	BQD6
		14k	NGB



For more information about what your Siemens RTAP Distributor can do for you, contact your local distributor.

<sup>1</sup> Screws are included with interior. Qty 1 equals 42 screws.

<sup>2</sup> For use with Revised P1 Panels only. Will not work with original P1.



**Published by  
Siemens Canada Limited**

Siemens Canada Limited  
Electrical Products  
1577 North Service Road East  
Oakville ON L6H0H6

**Customer Interaction Centre  
1-888-303-3353**

Order No.: SI-EP-1698  
All rights reserved  
Printed in Canada  
© 2022 Siemens Canada Limited

All product designations may be trademarks or product names of Siemens AG or supplier companies whose use by third parties for their own purposes could violate the rights of the owners. Subject to change without prior notice.